



Submarine Force Museum

Scout Scavenger Hunt Answer Key



Welcome. During your journey through the museum this scavenger hunt will help you learn how the 12 values found in the Scout Law tie into the history and heritage of the U.S. Navy Submarine Force. For each object fill in the blank with information found in the exhibits and write in what value is best represented. (Hint: Each is only used once)



2. Harman Automatic Steerman Device

Here the helmsman steers the rudder while the plansman operates the stern plans. As they are maneuvering the submarine, but cannot see where it is going it is important they follow orders, demonstrating the value of being obedient



1. Ship Control Panel



4. CAPT John Philip Cromwell

This device was more inexpensive than the Sperry Company's autopilot. So by adopting it the Navy demonstrated the value of being Thrifty



3. Torpedoman Henry Breault

Born in Putnam, CT he earned the Medal of Honor for saving a fellow shipmate. By refusing to abandon his companion he demonstrated the value of being Loyal



6. Bushnell's Turtle

He stayed aboard his sinking submarine because he possessed knowledge of ULTRA. By giving up his life rather than risk giving up secrets he had been entrusted with he demonstrated the value of being Trustworthy



5. USS Barb Battle Flag

CDR Eugene Fluckey commanded the USS Barb during WWII. The train depicted on the flag represents blowing up a Japanese train making them the only Allied forces to invade the Japanese home islands. By preserving artifacts like these to commemorate the heroic deeds of past crews, this museum demonstrates the value of being Reverent

Sergeant Ezra Lee of Lyme, CT was chosen to operate Bushnell's Turtle during its attack on the British fleet. By being the first submariner to launch an attack against an enemy using an experimental vessel and experimental weapons he demonstrated the value of being Brave



Submarine Force Museum

Scout Scavenger Hunt Answer Key



Choose the object, story or person you learned about in the museum that you think best represents the Boy Scout Motto, “Be Prepared”, and explain why you think so here:



8. Greetings from the North Pole

Due to President Kennedy's back injury, this elevator was especially constructed for his visit aboard SSBN 610. By accommodating someone's disability the crew demonstrated the value of being Kind

The crews of the Skate and the Seadragon played the world's first polar baseball game and greeted Santa Claus. By having fun, visiting each other and the North Pole's most famous citizen, these crews demonstrated the value of being Friendly



10. Black and White Doll

What material was this memo attempting to obtain? Answer: Toilet Paper
By keeping his sense of humor and making light of an uncomfortable situation CDR Coe demonstrated the value of being Cheerful

This black and white doll was used as a simple Clock by the crew of the Seafox. By assisting the crew in this way we can see that even a doll can demonstrate the value of being Helpful



12. VADM Levering Smith

Food is prepared for the crew in the Galley and served at tables in the crew's Mess. Both of these are areas where it would be very important to practice the value of being Clean

Well known for his reasoned or opened approach to each goal, he was a humble and patient individual who respected those he worked with. Because of all he accomplished by treating others in a considerate way, he is a good example of the value of being Courteous



7. Elevator



9. USS Skipjack Memo



11. City Beneath the Sea



Submarine Force Museum

Scout Scavenger Hunt Answer Key



First Deck Object Locations

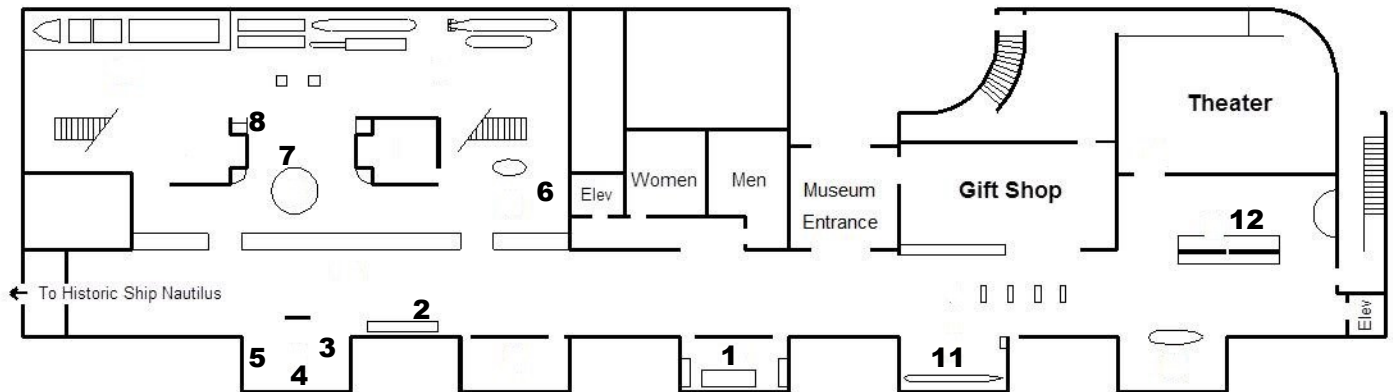

Second Deck Object Locations

